

LEA 20 kV

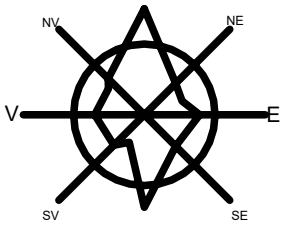

**RETEA LEA 20 kV**

## RETEA APA

**RETEA LEA 0.4 Kv**

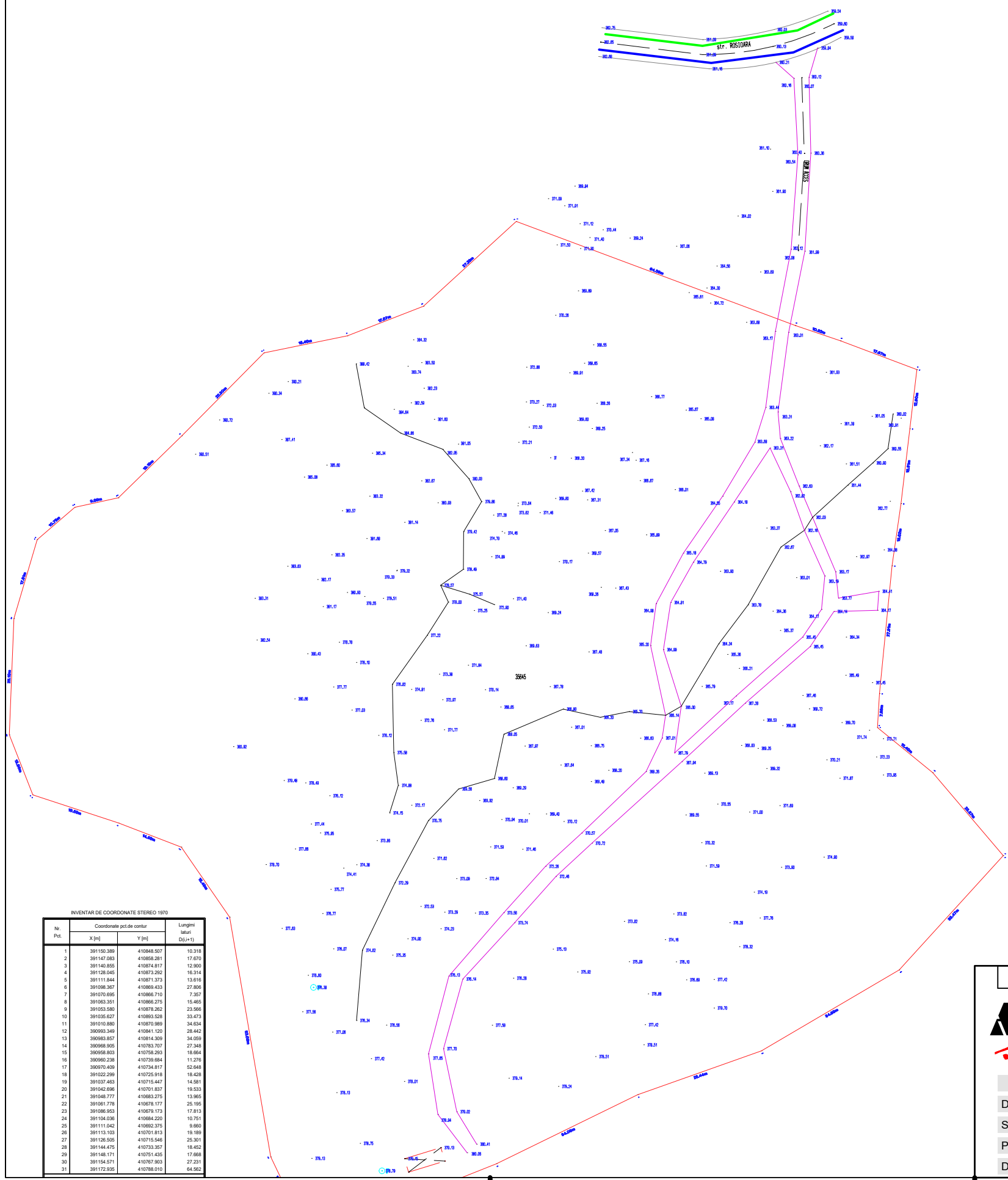

INVENTAR DE COORDONATE STEREO 1970				
Nr. Pict.	Coordonate pe dotul de control		Lungime latitudi D(1) [m]	
	X [m]	Y [m]		
1	191103.880	190848.507	12.918	
2	191077.403	190868.281	12.917	
3	191100.385	190874.817	12.910	
4	191129.040	190873.252	12.914	
5	191115.844	190870.373	13.013	
6	191098.387	190860.433	26.806	
7	191070.695	190866.710	7.567	
8	191066.275	190865.275	14.353	
9	190870.365	190870.265	23.266	
10	190870.267	190890.528	33.473	
11	191103.880	190870.989	34.034	
12	190870.365	190841.120	29.482	
13	190895.857	190814.309	37.409	
14	190890.905	190783.707	24.048	
15	190868.803	190788.203	28.049	
16	190890.228	190739.884	12.278	
17	190890.228	190734.817	12.626	
18	190822.398	190725.918	18.668	
19	190730.483	190715.447	14.951	
20	190824.696	190701.837	19.583	
21	190845.777	190685.275	13.863	
22	190870.178	190678.177	25.196	
23	190868.953	190673.177	17.193	
24	191113.038	190848.220	10.781	
25	191113.042	190862.375	9.960	
26	191113.038	190701.813	19.159	
27	191158.515	190715.546	25.868	
28	191144.474	190730.367	18.482	
29	191154.571	190751.435	17.001	
30	191154.571	190767.903	27.221	
31	191172.595	190781.035	66.632	

VERIFICATOR / EXPERT	NUME	SEMNĂTURA		
		R.C. J-38/42/2004 CUI R 16056520 RM. VILCEA STR.CALEA LUI TRAIAN NR. 164 BL 27, SC. C AP.8 tel/fax 0250-737667 mobil 0744-691147 email arhispace@gmail.com  director arh. ALEXANDRU SUCIU		NR. PROIECT
			<b>BENEFICIAR</b> <b>U.A.T. BERBESTI</b>	09.2025
				FAZA
			<b>PROIECT</b> Elaborare Plan Urbanistic Zonal- introducere in intravilan cu destinatie urbanistica zona de agrement, necesar realizarii Amenajare spatii verzi in Orasul Berbesti, Jud. Valcea, Zona 3 - Parc agrement	PUZ
				DATA
<i>specifica/ia</i>	<i>nume</i>	<i>semn'tura</i>		MAI 2025
DIRECTOR	arh. ALEXANDRU SUCIU			
SEF DE PROIECT	arh. ALEXANDRU SUCIU			
PROIECTANT	arh. ALEXANDRU SUCIU			
DESENAT	arh. E. SIMONA MENGONI			
			<b>AMPLASAMENT</b>	SCARA 1:1000
			Oras Berbesti, sat Rosioara, pct. "Izlaz", jud. Valcea	ARHITECTURA
			<b>PLANSA</b>	PLANȘA A05
			<b>REGLEMENTARI EDILITARE</b>	